

BLACK&DECKER® SKU #CC2000-CA/CC2001-CA

Special Features

Destroy Junk Mail without Opening It!

Black & Decker is committed to providing powerful solutions to make your life easier.

Our Identity Theft Buster junk mail shredder is so powerful, you can shred those pesky junk mail solicitations without even opening them – credit card and all – while protecting your identity.

Our new compact design gives you the freedom and flexibility to use the Identity Theft Buster anywhere you open your mail, from countertop to tabletop.

Auto Reverse

The Identity Theft Buster also features a special auto reverse feature. If what you are shredding begins to jam, the Identity Theft Buster automatically reverses to resist a potential jam. The Identity Theft Buster also includes simple forward and reverse buttons to work out of a paper jam if needed.



Sheet capacity: **20 20 lb. pages (10 folded) in one pass**
 Maximum running time: **3 minutes**
 Automatic cool-down period: **30 minutes**
 Voltage: **120**

BLACK&DECKER® SKU #CC2000-CA/CC2001-CA



Limited Lifetime Warranty

WHO IS COVERED:

This warranty covers only the original retail purchaser of the Black & Decker Paper Shredder who submits the warranty registration card within 90 days after purchase. This warranty is not transferable.

HOW LONG DOES COVERAGE LAST:

For cutter blades: Lifetime – as long as you own the product
 For all other parts: One year from the date of original purchase

WHAT IS COVERED:

Any defect in material or workmanship of your Black & Decker Paper Shredder

WHAT IS NOT COVERED:

This warranty does not cover damage due to misuse, abuse or accident such as:

- failure to maintain the product as provided in the Black & Decker Paper Shredder Instruction Manual
- commercial use
- improper or unauthorized repair or service
- fire, flood, "acts of God" or other contingencies beyond the control of HoMedics Group Canada

WHAT HOMEDICS GROUP CANADA WILL DO:

Repair, and if not possible, replace your Black & Decker Paper Shredder with a new or reconditioned model of the same type. If the model has been revised, you will receive the most current model.

HOW TO GET SERVICE:

Call the toll free customer service line at **1-888-225-7378**.

THE DURATION OF ANY IMPLIED WARRANTY OF MERCHANTABILITY IS LIMITED TO ONE YEAR. HOMEDICS GROUP CANADA SHALL NOT BE RESPONSIBLE FOR INCIDENTAL OR CONSEQUENTIAL DAMAGES ARISING OUT OF THE PURCHASE OR USE OF THE PAPER SHREDDER.

HOMEDICS Group
 Canada
 344 Consumers Road, Toronto, Ontario M2J 1P8

Black & Decker and the Black & Decker logo are trademarks of The Black & Decker Corporation and are used under license. All rights reserved.

BLACK&DECKER®

PROTECT YOUR IDENTITY WITH THE BRAND YOU TRUST™



SKU #CC2000-CA/CC2001-CA

Please read these instructions before use

BLACK&DECKER® SKU #CC2000-CA/CC2001-CA

Thank you for buying a Black & Decker paper shredder. **Black & Decker paper shredders** have become the benchmark for innovation, performance and quality to protect against identity theft. We have taken great care in designing and engineering a product to meet and exceed your needs.

To ensure years of safe, efficient performance, please read these important product usage and safety instructions.

Customer Service

Our customer service phone number is **1-888-225-7378**.

The Following Are Important Safety Instructions. Read All Instructions Before Using.

WARNING

- WARNING:** Hazardous moving parts. Keep fingers and other body parts away.
- WARNING:** To reduce risk of fire, electrical shock or injury:
- NEVER** allow children to operate a paper shredder, even under adult supervision. A paper shredder is **NOT** a toy.
- DO NOT** use flammable synthetic oil, petroleum-based products or aerosols of any kind on or near product at any time.
- DO NOT** operate any electrical product with a damaged cord.
- ALWAYS** keep the power cord clear of the shredder opening.
- AVOID** getting jewelry, hair or loose clothing too close to feed slot as serious injury can occur.
- DO NOT** handle plug or product with wet hands.
- ALWAYS** keep children and pets away from the shredder.
- ALWAYS** unplug shredder when not in use, before removing the shredder head to empty the bin, to perform routine maintenance, to clear a paper jam, and before handling the shredder head when transporting or storing shredder.
- DO NOT** attempt to feed more sheets of paper than specified on the feeder.
- DO NOT** attempt to shred materials other than paper or credit cards.
- ALWAYS** empty the wastebasket prior to becoming full.
- DO NOT** place shredder near heat or water source.
- ALWAYS** grip the shredder head firmly using both hands before removing it from the bin and when handling the shredder head, taking care to keep fingers clear of blades on underside of shredder head.
- DO NOT** open shredder head to attempt repair. It could expose you to electric shock and will void your warranty.
- NEVER** carry the shredder head by the cord.
- The socket-outlet shall be installed near the equipment and shall be easily accessible.

WARNING

ALWAYS KEEP CHILDREN CLEAR OF SHREDDER

WARNING ICONS: The icons on top of the shredder warn the user of the potential dangers if the shredder is used improperly.



BLACK&DECKER® SKU #CC2000-CA/CC2001-CA

Setup

- Check shredder for damage or defects. (To notice some particles of paper is normal due to product testing.)
- Plug the power cord into any easily reached standard outlet.
- To use, have the power switch (1), located on the back of the shredder, in the ON (-) position.
- Press the on/off switch (2) to activate the auto-feed mechanism.
- Place allotted amount of paper into the shredder. Shredder will automatically activate.

(=) indicates Forward
 (o) when illuminated auto-feed activated
 (-) indicates Reverse

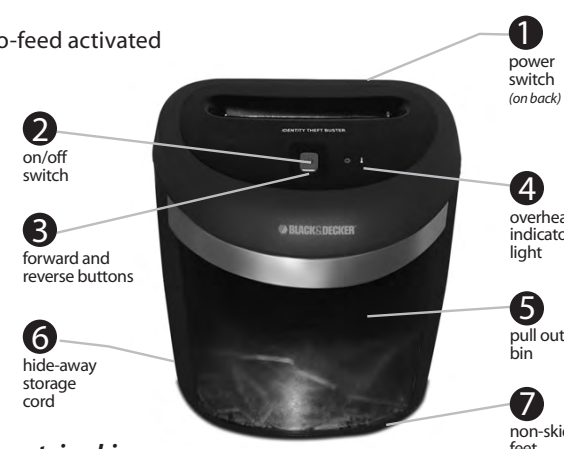

ALWAYS unplug before emptying bin.

Product Information

This product is built to shred paper, CDs, DVDs, credit cards, and staples. It is not built to shred large paper clips, continuous forms, adhesive labels, transparencies, newspaper, cardboard or other plastic. Using it for these purposes is likely to cause irreparable damage.

Forward and Reverse Buttons

Forward and reverse buttons surround the on/off switch. If jam occurs and auto reverse process stops, you can alternate between forward (=) and reverse (-) to work out of a jam. Refer to the Troubleshooting Section for more details.



Indicator Light

To provide ease-of-use, your Black & Decker paper shredder has an indicator light as visual cues to communicate any problems.

If the light next to the thermometer icon is illuminated, this means the shredder needs to cool down. Simply turn off the shredder and let cool for approximately 30 minutes.

BLACK&DECKER® SKU #CC2000-CA/CC2001-CA

Maintenance

ALWAYS UNPLUG shredder before performing any maintenance. It is important to empty the waste bin regularly to ensure the smooth operation of the cutting cylinders. Regular oiling is also necessary for proper performance. It is recommended to use the shredder oil every few weeks. Do not use flammable synthetic oil, petroleum-based products or aerosols of any kind on or near product at any time. Shredder oil may be purchased at most retailers in the shredder section of the store.

Troubleshooting

If you have a problem with your shredder, check the symptoms and remedies below. If you cannot solve the problem this way, contact Black & Decker paper shredders Customer Service. **Do not open shredder head to attempt repair: It could expose you to electric shock and will void your warranty.**

Symptom	Remedy
Shredder does not start or stops while shredding.	- Make sure shredder is plugged in, power switch on back of unit (1) is in the ON (-) position, and push on/off switch (2) so that it is illuminated, and on.
Shredder overheat indicator light is on.	- Wait 30 minutes for shredder to cool down before trying again. If shredder is overheated, indicator light (4) will be on.
Paper jam.	- In case of a paper jam, which may occur if the sheet capacity is exceeded or if paper is not put in straight, turn off the shredder, unplug and empty the bin (5) if full. Prepare shredder for use. Then: 1. If the shredder remains jammed, use the forward and reverse buttons (3) surrounding the on/off switch (2) marked (=) for forward and (-) for reverse. Alternate the buttons between forward and reverse to clear the jam. 2. If the jam still does not clear, unplug shredder and carefully grasp the paper and pull out slowly. 3. Once the jam is cleared, plug in, turn on and press the on/off switch to continued shredding.
Shredder squeaks, grinds or runs below capacity.	- Oil cutting cylinders regularly.
Shredder continues to run for 2 or 4 seconds after shredding has been completed.	- No action required. This is a self-cleaning function.